

LED Mirrors - Fitting Instructions

We always recommend using a qualified professional to fit this product.

This mirror wired directly into a 240v supply.

There is a transformer built in behind the mirror that's steps it down to 12v.

1. Measure the distance between the hangers on the mirrors frame. Drill 2 level holes (spirit level is important). Use the required expanding fixing for your wall. Drive the screws into the wall fixings – leaving 6-8mm showing.

2. Connect the wires as shown

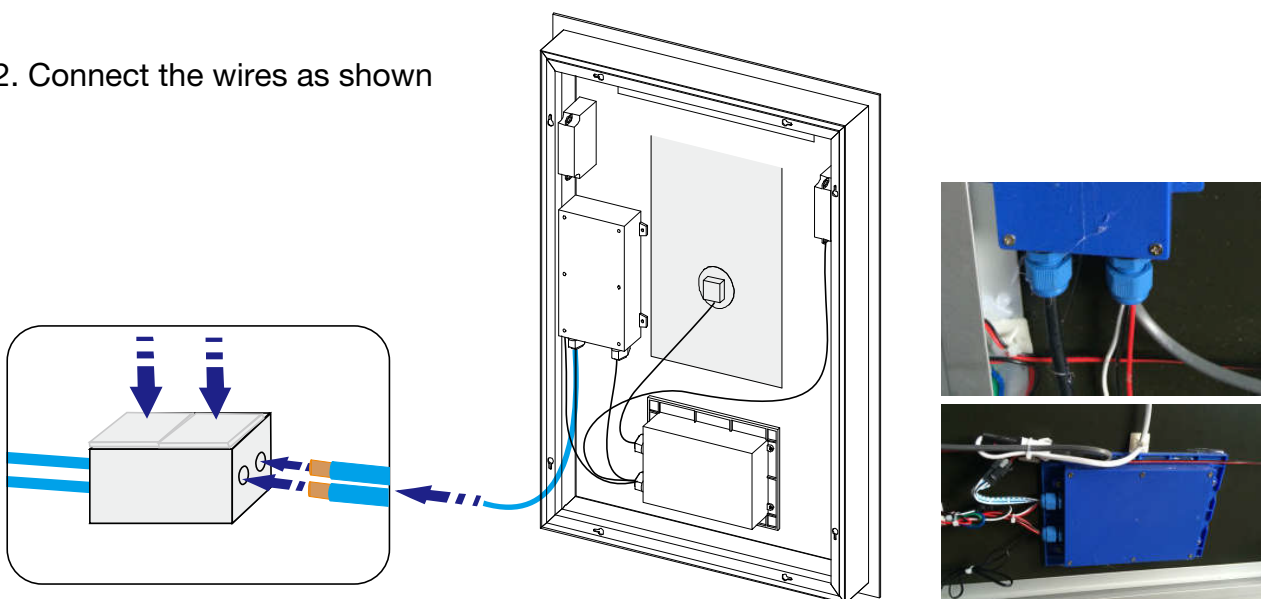

3. Hang the mirror onto the 2 screws.
Release slowly to make sure the mirror feels stable and tight.

