

These curtain rails are manufactured from aluminium and are powder coated to give a good looking, hygienic and tough finish.

## Fitting instructions:

1. Measure and mark

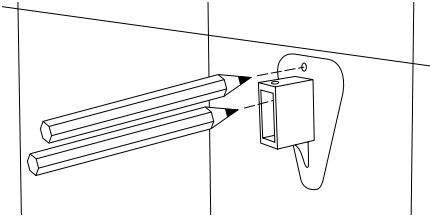

2. Drill and fix the wall bracket.

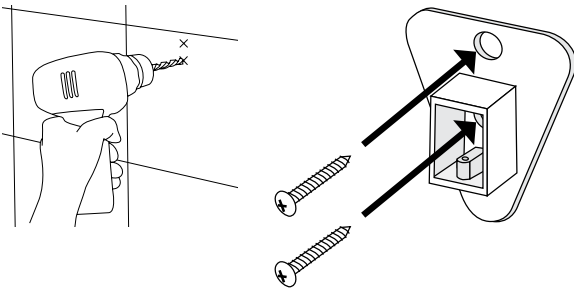

3. Cut the rail into the appropriate length.

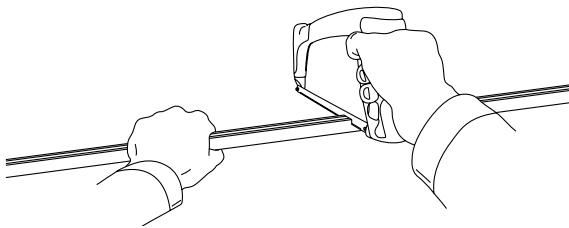

4. Connect the aluminum rail with the connectors.

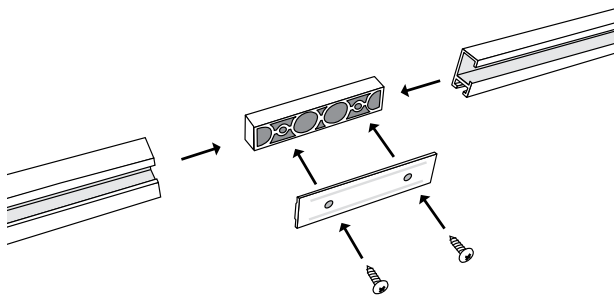

5. Measure the length of the ceiling support pipe.

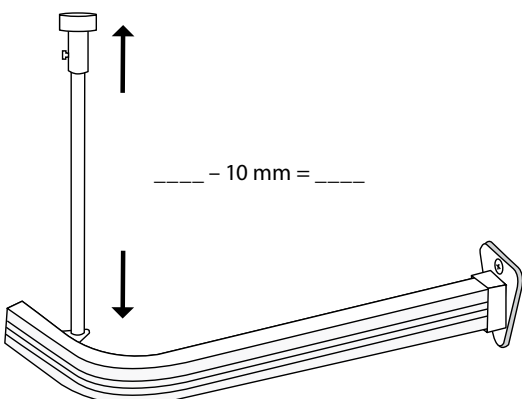

6. Cut the ceiling support pipe into suitable length.

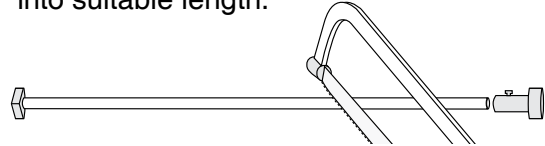

7. Drill and fasten the ceiling support pipe.

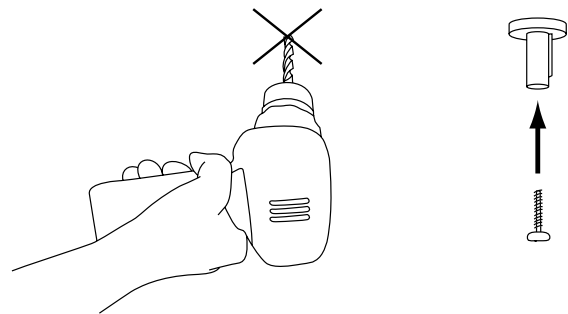

8. Hang the curtain hooks to the rail.

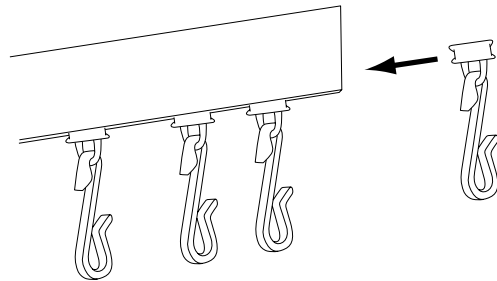

9. Screw the aluminum rail firm.

